

# **My Air Buddy And I**

**Version: 1.07.02 Beta**

**Build: 76**

**Released Date: 3/6/2026**

**Language: English**

**Unit of Measure: Imperial**

**Quick Start**

3:24



\* 🔊 📶 🔋 49%



## Waiver

ACCEPT

REFUSE

### PLEASE READ this waiver.

In no way will Michel Marin or any other person, but yourself, be responsible for your use of this application. You use any calculations and estimations provided by this application at your own risk, and should perform your own calculations before diving.

This application is provided as is, and without any claims of fitness for purpose. It is provided as a theoretical tool for fast estimations, and **must not** be used as the sole tool for planning dives.

You are responsible for explaining this agreement to any third party who may use this application on your equipment.

You can read, accept or refuse this waiver any time by clicking Waiver in the main menu.

Initial display.

Select ACCEPT or REFUSE.



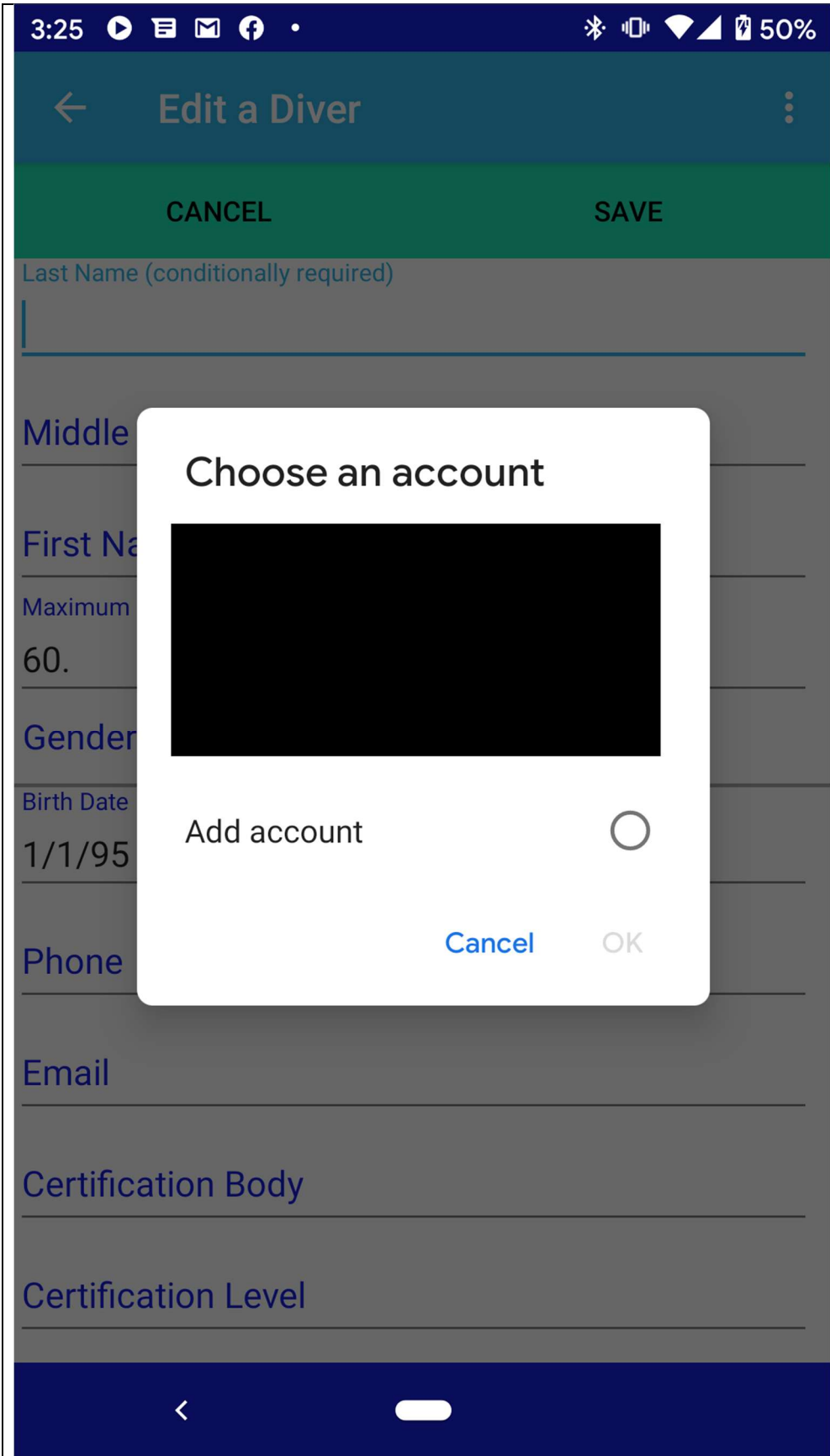

Choose to add an account or Cancel.

MABAI does nothing with the email account.

It is reserve for future use.

12:32 31 M 59%

← Edit a Diver

CANCEL SAVE

Last Name (conditionally required)  
MyLastName

Middle Initial

First Name (conditionally required)

Maximum Depth (ft) Allowed (required)  
60.0

Gender  Man  Woman

Birth Date

Phone

Email

Certification Body

Certification Level

You must either enter your last name or first name or both.

Make sure to specify your Maximum Depth Allowed.

MABAI defaults to Man.

Select SAVE.

Add your first Dive by selecting the Dive icon



# My Air Buddy and I



**Me**

**Dive Type**  
Average

**No Buddy**

No Group  
0.000

**Equipment Group**  
**RMV**

No Group  
0.000

00:00:00

**To Date**

00:00:00

**Last Dive**  
**Surface Interval**





# Pick a Dive



LBN	Date/Time	Status	My Buddy
Location		Dive Site	

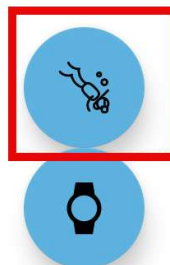

Your Dive list is empty at the beginning.

Add your first Dive by selecting the Dive icon.

# Edit a Dive #1

CANCEL

SAVE



## Planning

Status

Plan

Dive Type

Typical

Salinity  Salt

Fresh

Me

No Buddy

Equipment Group

Equipment Group

Pick an Equipment Group

Pick an Equipment Group

SAC

RMV

SAC

RMV

38.4

1.0

0.0

0.0

Planning

Note

Select Pick an Equipment Group

# ← Pick an Equipment Group #1



CANCEL

PICK

Type	Description	Dives
Double	AL80Dou/Pony	0
Detail		
Double	AL80Dou/Technical1	0
Double	AL80Dou/Technical2	0
Sidemount	AL80Sid/Pony	0
Single	AL80Sin	0
Single	AL80Sin/Pony	0



Select your Equipment Group to select and expand it

# ← Pick an Equipment Group #1



CANCEL

PICK

Type	Description	Dives
	Double AL80Dou/Pony	0
	Double AL80Dou/Technical1	0
	Double AL80Dou/Technical2	0
	Sidemount AL80Sid/Pony	0
	Single AL80Sin	0
	Detail	
	Single AL80Sin/Pony	0



Select your Equipment Group.

Select PICK.

# ← Edit a Dive #1

CANCEL

SAVE



## Planning

Status

Plan

Dive Type

Typical

Salinity  Salt

Fresh

Me

No Buddy

Equipment Group

Equipment Group  
Pick an Equipment Group

SAC **AL80Sin** RMV

SAC RMV

38.4 1.0

0.0 0.0

Planning

Note

Equipment Group has been added.

Select Planning.



# Build a Dive Plan #1



Order No

Minute

Depth



Your Plan list is empty for every new Dive.

Select Add a Plan.



# Edit a Dive Plan #1



CANCEL

SAVE

Time (min.) (required)

30

Depth (ft) (required)

30

Order No (required)

10

Enter Time and Depth.

Select SAVE.



4:07



Bluetooth, Signal, Wi-Fi, and Battery 58%

Select Back (←)



# Build a Dive Plan #1



Order No

Minute

Depth

10

30

30.0



Detail



# Edit a Dive #1

CANCEL

SAVE



## Planning

Status

Plan

Dive Type

Typical

Salinity  Salt

Fresh

Me

Equipment Group

AL80Sin

SAC

RMV

38.4

1.0

No Buddy

Equipment Group

Pick an Equipment Group

SAC

RMV

0.0

0.0

30 Minute(s) @ 30.0 ft

Note

The Planning is showing.

Select SAVE.



# Pick a Dive



LBN	Date/Time	Status	My Buddy
Location		Dive Site	



1 7/10/25 13:07 Plan No Buddy



Location not specified Location not specified



Det.



Turn



Ro3s



Drift



Rock



Pony



**End of document**